

**REVISIONS**

DATE: 2/27/13 : PARCEL 55; REVISED R/W  
DATE: 2/27/13 : PARCELS 52, 54, 57; COMBINED INTO PARCEL 52  
DATE: 2/27/13 : PARCEL 73; REVISED CURBING AND PAVEMENT REMOVAL  
DATE: 2/27/13 : PARCEL 70; REVISED R/W

DATE: 2/27/13 : PARCEL 78; REVISED PROPERTY NAME  
DATE: 2/27/13 : PARCELS 52, 54, 57; COMBINED INTO PARCEL 52  
DATE: 2/27/13 : PARCEL 73; REVISED CURBING AND PAVEMENT REMOVAL  
DATE: 2/27/13 : PARCEL 70; REVISED R/W

-L-	-Y8-	-Y9-
PI Sta 54+71.63	PI Sta 11+10.18	PI Sta 11+16.99
$\Delta = 16^{\circ} 58' 24.2''$ (RT)	$\Delta = 47^{\circ} 32' 44.1''$ (LT)	$\Delta = 45^{\circ} 50' 51.9''$ (RT)
D = 108' 45.3'	D = 37' 12' 18.2"	D = 37' 12' 18.2"
L = 1,481.2'	L = 111.67'	L = 123.23'
T = 746.07'	T = 58.42'	T = 65.13'
R = 5,000.00'	R = 154.00'	R = 154.00'
DS > 40 MPH	DS = 25 MPH	DS = 25 MPH
SE = NC	SE = NC	SE = NC
RO = NONE	RO = NONE	RO = NONE

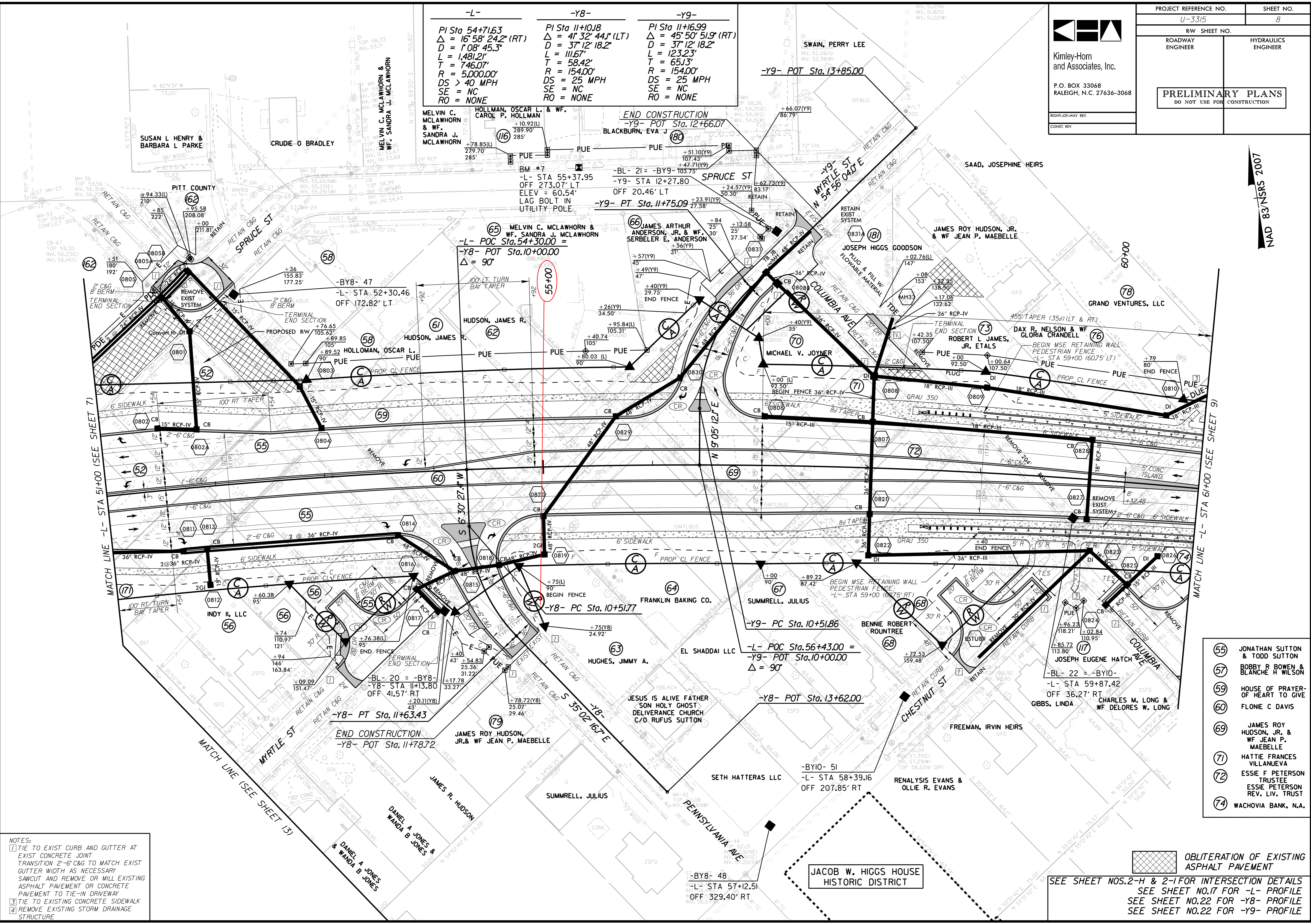

- (55) JONATHAN SUTTON & TODD SUTTON
- (57) BOBBY R BOWEN & BLANCHE H WILSON
- (59) HOUSE OF PRAYER- OF HEART TO GIVE
- (60) FLONIE C DAVIS
- (69) JAMES ROY HUDSON, JR. & WF JEAN P. MAEBELLE
- (71) HATTIE FRANCES VILLANUEVA
- (72) ESSIE F PETERSON TRUSTEE  
ESSIE PETERSON REV. LIV. TRUST
- (74) WACHOVIA BANK, N.A.

**NOTES:**

1) TIE TO EXIST CURB AND GUTTER AT EXIST CONCRETE JOINT  
TRANSITION 2'-6" C&G TO MATCH EXIST GUTTER WIDTH AS NECESSARY  
SAWCUT AND REMOVE OR MILL EXISTING ASPHALT PAVEMENT OR CONCRETE PAVEMENT TO TIE-IN DRIVEWAY

2) TIE TO EXISTING CONCRETE SIDEWALK

3) REMOVE EXISTING STORM DRAINAGE STRUCTURE

OBLITERATION OF EXISTING ASPHALT PAVEMENT

SEE SHEET NOS. 2-H & 2-I FOR INTERSECTION DETAILS  
SEE SHEET NO. 17 FOR -L- PROFILE  
SEE SHEET NO. 22 FOR -Y8- PROFILE  
SEE SHEET NO. 22 FOR -Y9- PROFILE

K:\RAL\_Roadway\01036715 U-3315\Roadway\Pro\U-3315\_rdy\_psr08.dgn

4/4/2013





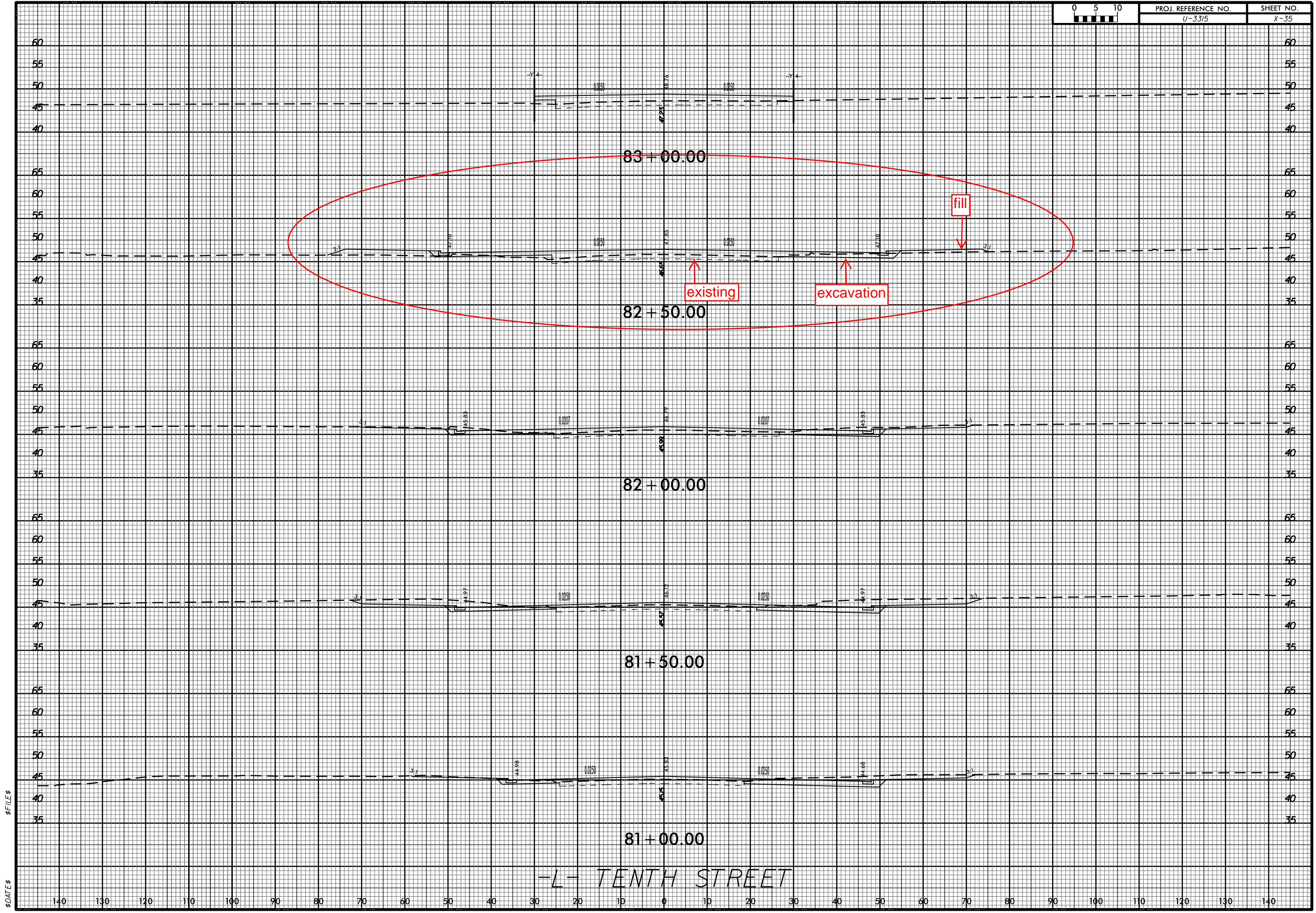

\$DATE\$

-L- TENTH STREET